



A Leader in Education  
and Research on the  
Built Environment

BCA ACADEMY  
of the built environment

# DIPLOMA IN DESIGN (INTERIOR AND LANDSCAPE)

Presented by Kwang Chan Nam  
Programme Manager/Senior Lecturer  
SBD/BCA Academy

The education and research arm of the Building and Construction Authority



A Leader in Education  
and Research on the  
Built Environment

BCA ACADEMY  
of the built environment

## Diploma in Design (Interior & Landscape)



**Provides foundation knowledge in landscape and interior design with an emphasis on designing and managing decorative and display projects.**

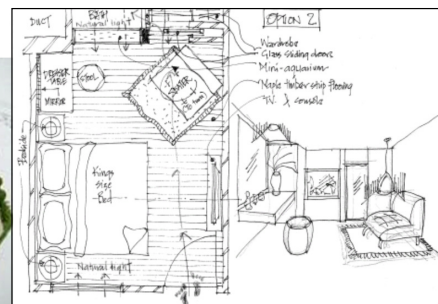
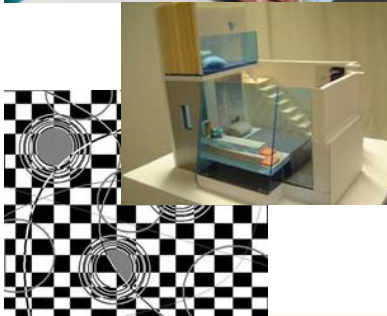

The education and research arm of the Building and Construction Authority



A Leader in Education  
and Research on the  
Built Environment

**BCA ACADEMY**  
of the built environment

## Programme Structure

YEAR 1	YEAR 2	YEAR 3
DCS049 Building Technology	DPQ612 Management Systems for Construction	DLA122 Landscape Site Planning
DID101 Design and Creative Methods	DID108 Interior Construction 2	DLA124 Skyrise Greenery
DID104 Design Studio 1	DLA116 Landscape Technology	DLA120 Landscape Styles
DID106 Evolution of Interior Design	DLA121 Planting Design & Management	DID127 Design Studio 3 - Retail
DID107 Interior Construction I	DID125 Design Studio 2 - Residential	DID128 Design Studio 3 - Leisure
DID110 Scenography	DID126 Design Studio 2 - Office	DLA130 Landscape Design 2
DDG807 CAD 1	DLA129 Landscape Design 1	DDG816 3D CAD
DDG808 CAD 2	DBS205 Building Services	DCM862 Technical Communications
DDG810 Drawing Presentations	DPC419 Procurement Management	DFP927 Final Year – Industrial Attachment
DPD877 Life Skills A	DPR712 Project Management	DAR131 Building Regulations
DPD878 Life Skills B	DBU706 Elements of Business	DBI863 Advance BIM for Architecture
DLW917 Basic Business Law	DPD879 Management Skills A	
DIT835 Digital Media Presentation	DPD880 Management Skills B	
	DBI859 BIM for Architecture	

The education and research arm of the Building and Construction Authority



A Leader in Education  
and Research on the  
Built Environment

**BCA ACADEMY**  
of the built environment

## 3 Year Diploma Programme focuses on Applications of Interior Design and Landscape

1. Basic drafting and free hand sketching
2. CAD – 2D and 3D
3. Interior Construction Technology
4. Landscape Design
5. Interior Design
6. Final Design project

The education and research arm of the Building and Construction Authority



A Leader in Education  
and Research on the  
Built Environment

**BCA ACADEMY**  
of the built environment

## Students' projects

- Freehand sketching
- 2D patterns
- 3D art
- CAD
- Room models
- Exhibition, Apartment designs
- Office, Retail designs
- Landscape design



The education and research arm of the Building and Construction Authority



A Leader in Education  
and Research on the  
Built Environment

**BCA ACADEMY**  
of the built environment

## Freehand sketching

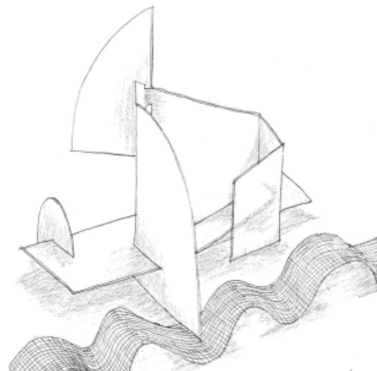
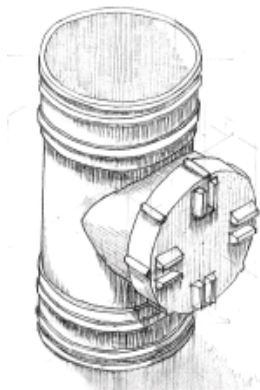

The education and research arm of the Building and Construction Authority



A Leader in Education  
and Research on the  
Built Environment

**BCA ACADEMY**  
OF THE BUILT ENVIRONMENT

# Technical drawing

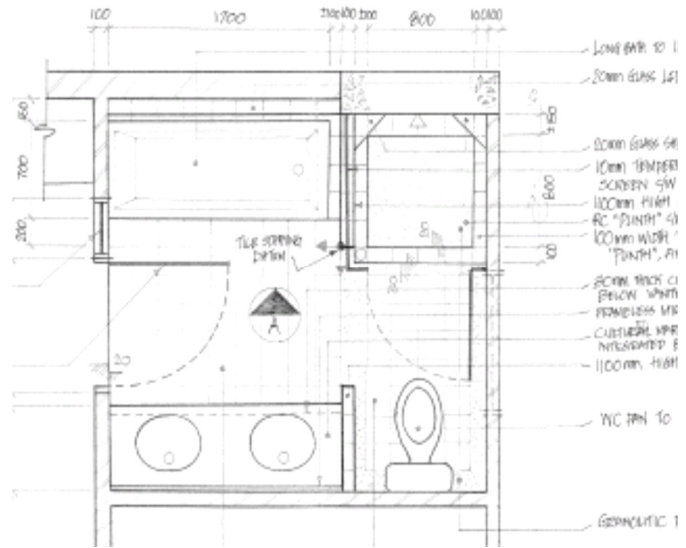

The education and research arm of the Building and Construction Authority



A Leader in Education  
and Research on the  
Built Environment

**BCA ACADEMY**  
OF THE BUILT ENVIRONMENT

# 2D design

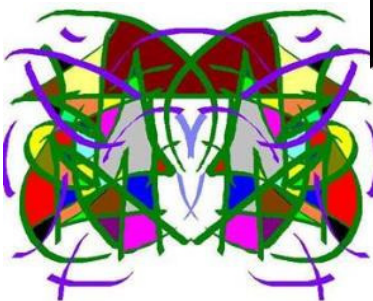
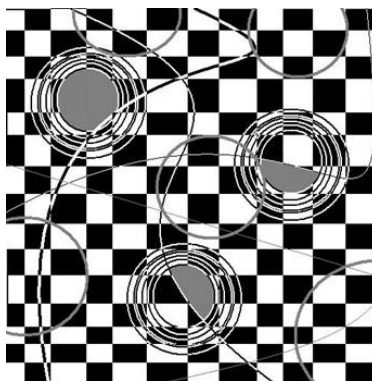

The education and research arm of the Building and Construction Authority



A Leader in Education  
and Research on the  
Built Environment

**BCA ACADEMY**  
of the built environment



## 3D sculptures

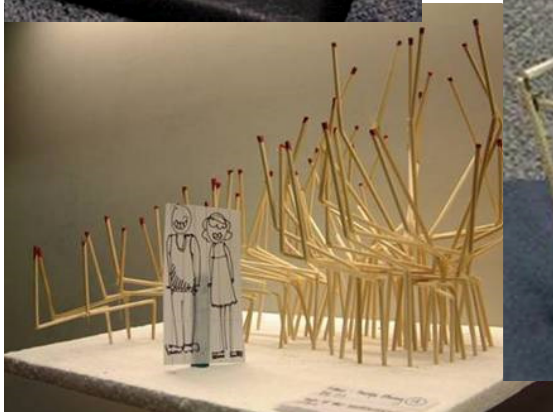

The education and research arm of the Building and Construction Authority



A Leader in Education  
and Research on the  
Built Environment

**BCA ACADEMY**  
of the built environment

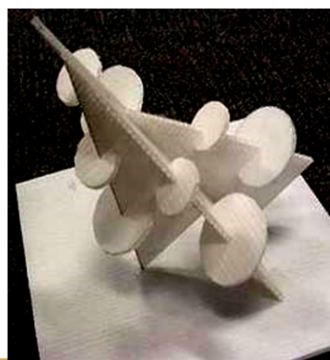

The education and research arm of the Building and Construction Authority



A Leader in Education  
and Research on the  
Built Environment

**BCA ACADEMY**  
of the built environment

## Creative 3D models

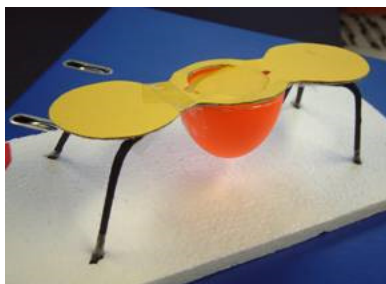
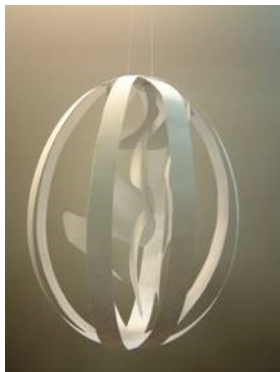
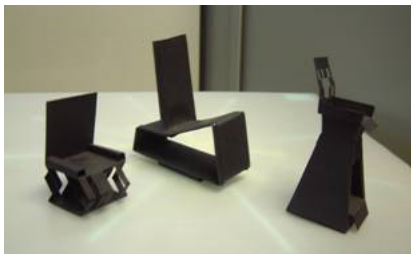

The education and research arm of the Building and Construction Authority



A Leader in Education  
and Research on the  
Built Environment

**BCA ACADEMY**  
of the built environment

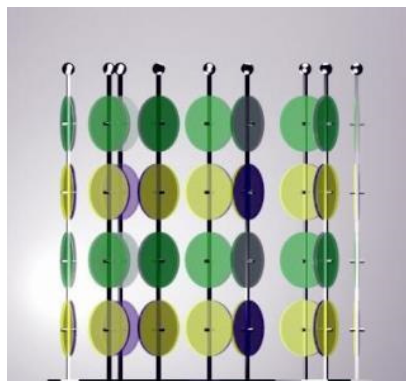

The education and research arm of the Building and Construction Authority



A Leader in Education  
and Research on the  
Built Environment

**BCA ACADEMY**  
of the built environment



# Rhythm

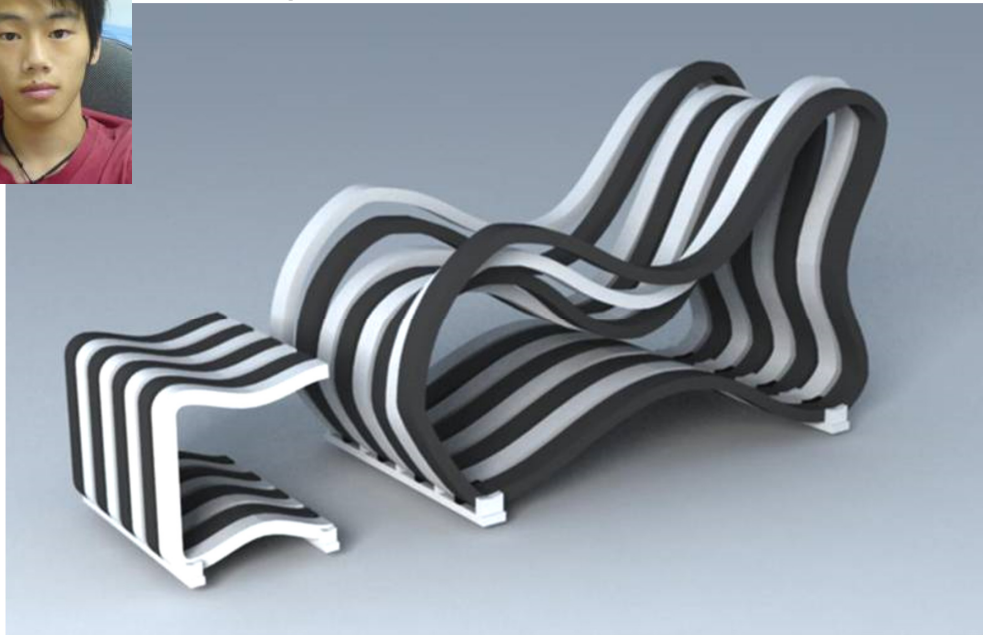

The education and research arm of the Building and Construction Authority



A Leader in Education  
and Research on the  
Built Environment

**BCA ACADEMY**  
of the built environment

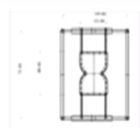

5 views1 (PLAN).jpg



5 views2 [RIGHT].jpg



5 views3 [FRONT].jpg

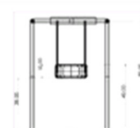

5 views4 [LEFT].jpg



5 views5 [BACK].jpg



Daniel Wee.JPG

The education and research arm of the Building and Construction Authority



A Leader in Education and Research on the Built Environment

BCA ACADEMY  
of the built environment

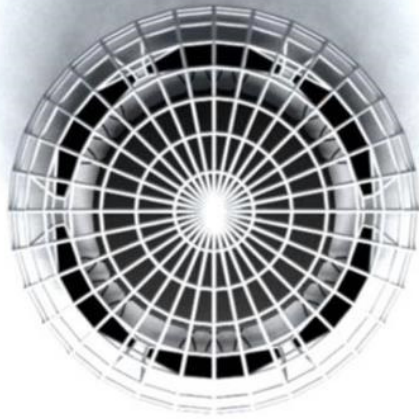

'Qi' seat

Bow lounge



The education and research arm of the Building and Construction Authority



A Leader in Education and Research on the Built Environment

BCA ACADEMY  
of the built environment

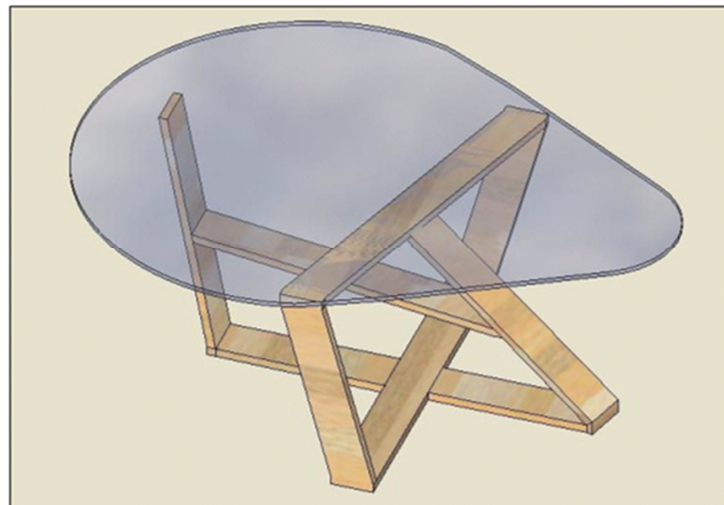

back.jpg



e1.jpg



e2.jpg



liao xingxing.jpg



p1.jpg



p2.jpg

The education and research arm of the Building and Construction Authority





A Leader in Education and Research on the Built Environment

BCA ACADEMY  
of the built environment



# Chaos

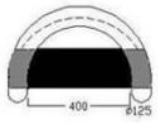

Plan

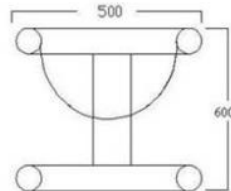

Front Elevation

The education and research arm of the Building and Construction Authority



A Leader in Education and Research on the Built Environment

BCA ACADEMY  
of the built environment

**CAT & THE FIDDLE**  
SPECIAL TOPIC CREATION

Cat & The Fiddle Design concept by Li Xin Chun  
Pin No.: 029918288  
Class: 1311L3B

**Appearance Design**

Let's bring the picture to life! It's almost like a picture in the middle to look at. So the background color should be very vibrant. There are not too many colors to choose, what the picture shows more clearly.

**Layout**

Under the condition of the space allow, the layout can be divided into two parts:  
1. The food serving area  
2. Some things placed to customers to choose

**Tasting Area**

1,2 Kitchen  
3.1.1 Tasting area  
4. Conveyer belts

**Display Area**

It is to mix with the modern style. The main feature is clean and tidy.

**Internal UD Features 1 Living & Dining space [1<sup>st</sup> floor]**

1. The chair and the modern style. The main feature is clean and tidy.

2. The chair and the modern style. The main feature is clean and tidy.

3. The chair and the modern style. The main feature is clean and tidy.

4. The chair and the modern style. The main feature is clean and tidy.

5. The chair and the modern style. The main feature is clean and tidy.

6. The chair and the modern style. The main feature is clean and tidy.

7. The chair and the modern style. The main feature is clean and tidy.

8. The chair and the modern style. The main feature is clean and tidy.

9. The chair and the modern style. The main feature is clean and tidy.

10. The chair and the modern style. The main feature is clean and tidy.



**LEGO COMPETITION**  
SCHOOL: BCA ACADEMY Tutor: Yan May Chee Maggie  
Chen Kaixin Chen Qitian Kuang Jianyi Liang Jiaping

The education and research arm of the Building and Construction Authority



A Leader in Education  
and Research on the  
Built Environment

**BCA ACADEMY**  
of the built environment



The education and research arm of the Building and Construction Authority



A Leader in Education  
and Research on the  
Built Environment

**BCA ACADEMY**  
of the built environment

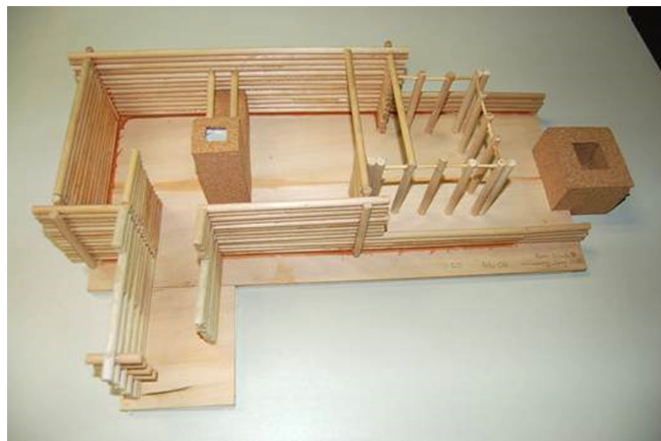
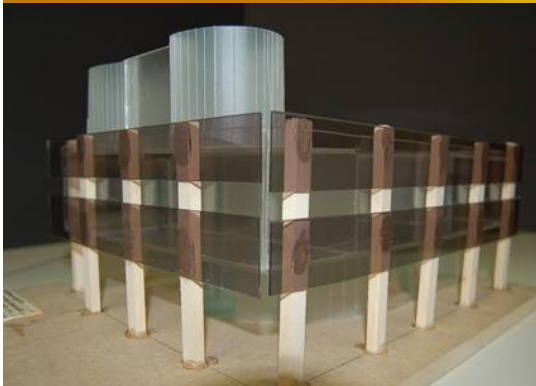

The education and research arm of the Building and Construction Authority



A Leader in Education  
and Research on the  
Built Environment

**BCA ACADEMY**  
of the built environment



The education and research arm of the Building and Construction Authority



A Leader in Education  
and Research on the  
Built Environment

**BCA ACADEMY**  
of the built environment



PERPECTIVE VIEW

The education and research arm of the Building and Construction Authority



A Leader in Education  
and Research on the  
Built Environment

**BCA ACADEMY**  
of the built environment



### Restroom Design

The education and research arm of the Building and Construction Authority



A Leader in Education  
and Research on the  
Built Environment

**BCA ACADEMY**  
of the built environment

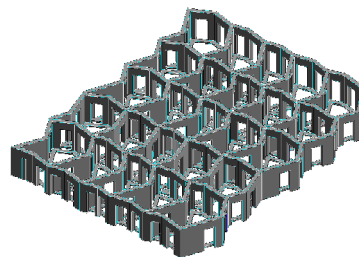

The education and research arm of the Building and Construction Authority



A Leader in Education  
and Research on the  
Built Environment

**BCA ACADEMY**  
of the built environment

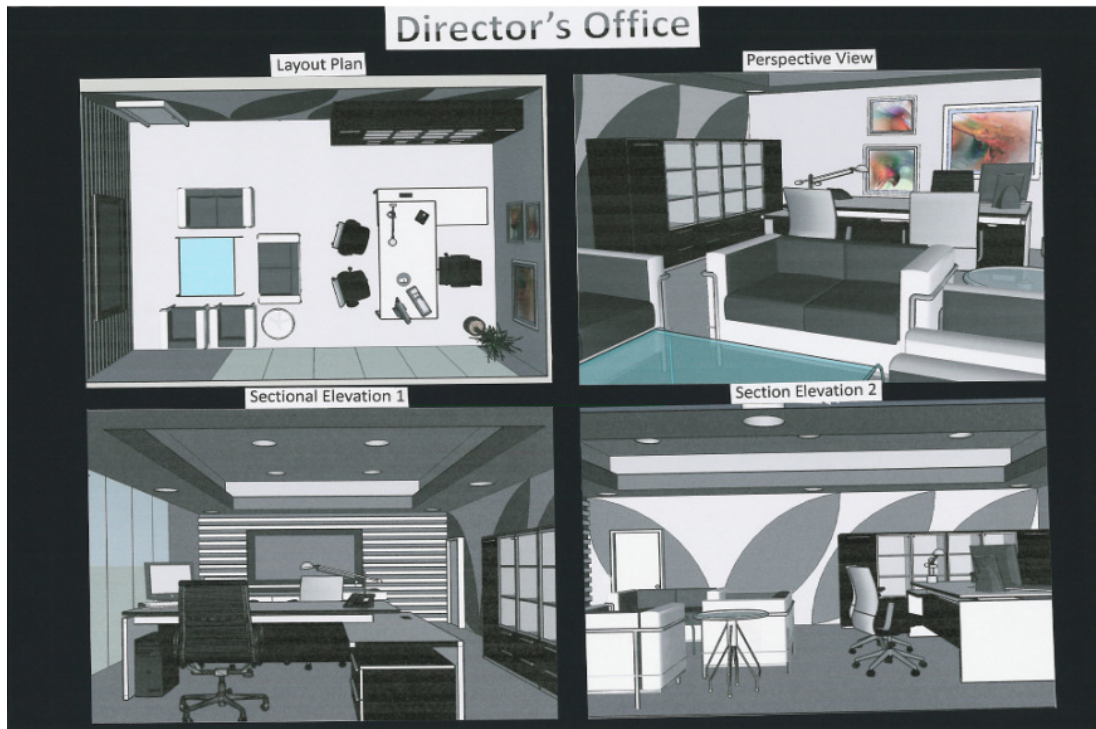

The education and research arm of the Building and Construction Authority



A Leader in Education  
and Research on the  
Built Environment

**BCA ACADEMY**  
of the built environment

## LANDSCAPE DESIGN

### CONCEPT IMAGES



The education and research arm of the Building and Construction Authority



A Leader in Education  
and Research on the  
Built Environment

**BCA ACADEMY**  
of the built environment

PRODUCED BY AN AUTODESK EDUCATIONAL PRODUCT



**Concept Plan**

Scale: 1:200

PRODUCED BY AN AUTODESK EDUCATIONAL PRODUCT



The education and research arm of the Building and Construction Authority



A Leader in Education  
and Research on the  
Built Environment

**BCA ACADEMY**  
of the built environment

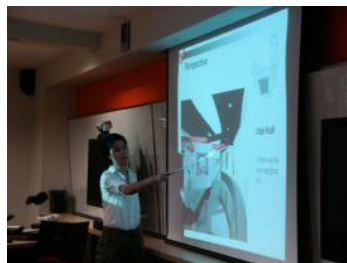

The education and research arm of the Building and Construction Authority



A Leader in Education  
and Research on the  
Built Environment

**BCA ACADEMY**  
of the built environment



The education and research arm of the Building and Construction Authority



A Leader in Education  
and Research on the  
Built Environment

**BCA ACADEMY**  
of the built environment

## Universities to further your studies

### **FURTHER STUDIES**

Graduates of the Diploma in Design (Interior & Landscape) may choose to further their studies at these universities:

- CURTIN UNIVERSITY OF TECHNOLOGY, AUSTRALIA  
Bachelor of Arts (Interior Architecture)
- UNIVERSITY OF SOUTH AUSTRALIA, AUSTRALIA  
Bachelor of Interior Architecture
- UNIVERSITY OF TECHNOLOGY, SYDNEY  
Bachelor of Construction Project Management

The education and research arm of the Building and Construction Authority



A Leader in Education and Research on the Built Environment

BCA ACADEMY

## Profiles of Past Design Graduates



2009 Gold Award winner

**Nant Saw Thandar**



2011 Silver Award Winner

**Wu Jing Jie**

(Working in DP Architect Pte Ltd)



2013 Silver Award Winner

**Zhang Bo Jun**

(Working in DP Architect Pte Ltd)

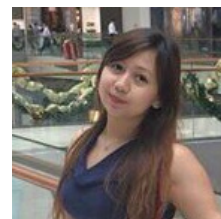

Graduate 2015

**Khine Pyae Sone Thu**

(Director, Nay La Dana Construction Co)

The education and research arm of the Building and Construction Authority



A Leader in Education and Research on the Built Environment

BCA ACADEMY



Featured in  
Shin Min Daily  
News on 20th  
November 2015

- Ken Fong – Diploma in Design student delivering valedictory speech during 2015 graduation ceremony.





A Leader in Education  
and Research on the  
Built Environment

BCA ACADEMY  
of the Built Environment

## Status of Design Graduates (2014)

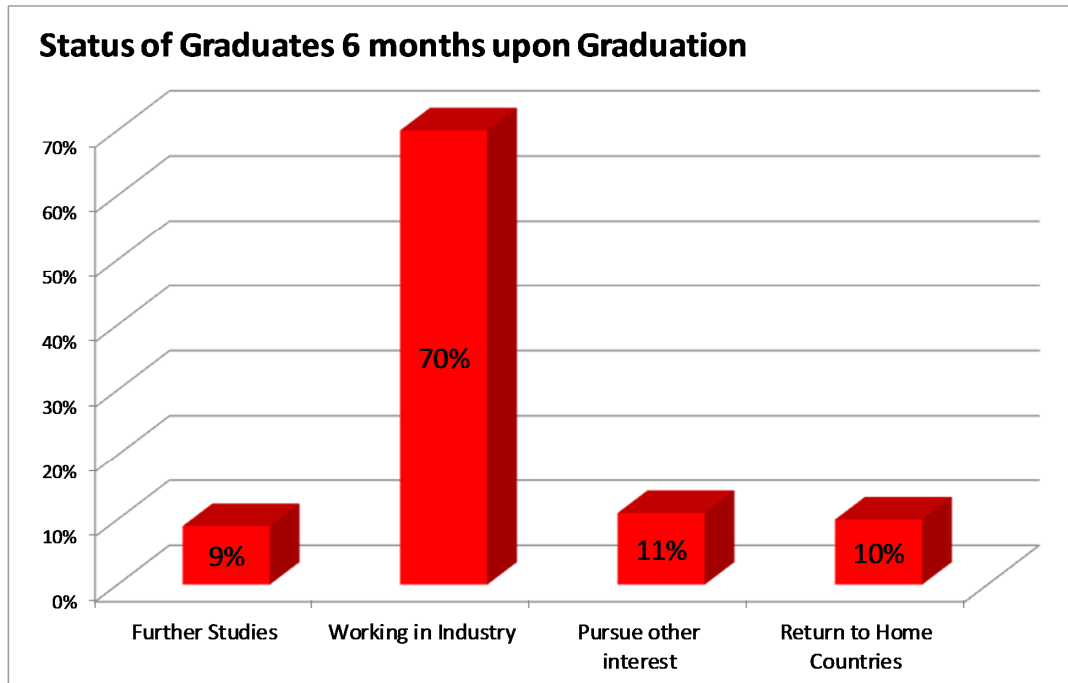

The education and research arm of the Building and Construction Authority



A Leader in Education  
and Research on the  
Built Environment

BCA ACADEMY  
of the Built Environment



The education and research arm of the Building and Construction Authority



A Leader in Education  
and Research on the  
Built Environment

**BCA ACADEMY**  
OF THE BUILT ENVIRONMENT

# Thank You

The education and research arm of the Building and Construction Authority